

# KITCHENS

The range hood and vertical cabinets create an interesting contrast to the horizontal lines of the drawer banks, backsplash tiles and long, stainless steel countertop.

Pulls, Summerhill Hardware; range hood, Sears; backsplash tiles, Sabilo Imports; white pot, Word of Mouth; stereo, Bay Bloor Radio.



CHILL  
AND SERVE

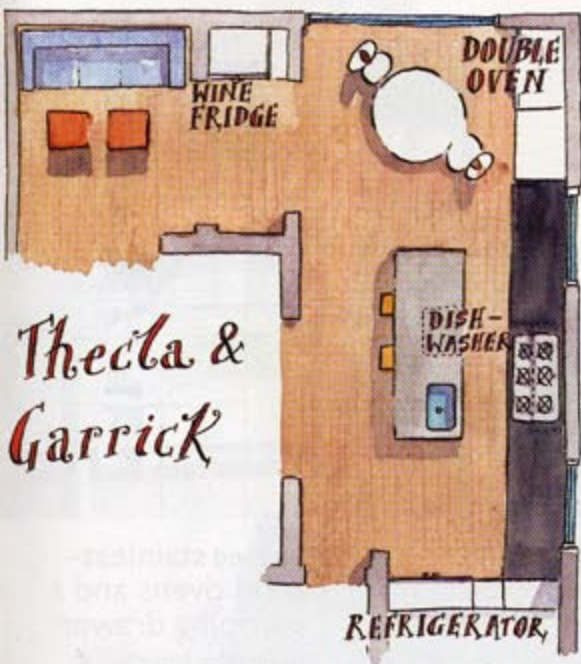

**RIGHT:** The big, deep sink does double duty as a spot for Thecla to arrange flowers. The backsplash is a frieze of different-sized tiles of grey-veined Carrara marble. Faucet, HansGrohe.

**BELOW LEFT:** Under his parents' cookbooks, Oscar has his own accessible shelves.

**BELOW CENTRE:** Thecla and Garrick serve hors d'oeuvres for guests to nibble on in the kitchen while they cook. Platter, Northdale Trading; knives, Pottery Barn.

**BELOW:** Garrick Tiplady and two-year-old Oscar.



The sofa in the sitting area echoes the kitchen's grey tones, the cork-covered ottomans its wood flooring. Ottomans, L'Atelier; sofa, Sarah Richardson Design; Marcia Myers painting, Galerie de Bellefeuille.



## Thecla Sweeney is the first to

admit that she's a neat freak. When she and her husband, Garrick Tiplady, took on the renovation of the main floor of their Edwardian-era Toronto house, designer Sarah Richardson had to take this into account, along with the fact that the couple and their two-year-old son, Oscar, frequently entertain friends and their large extended families.

"They love to entertain, and they like to keep things sleek, clean and modern," says Richardson. "So I found myself thinking of the simplicity of a large-scale catering kitchen with maximum countertop and storage space." The solution for what became an 850-square-foot kitchen and sitting room was found in a monumental, 10-foot-long island topped with "the largest slab of grey marble we could find," says Richardson. A seamless bank of custom, lab-style cabinetry under the sink and stovetop and flanking the refrigerator and ovens provides reams of storage and banishes any clutter.

The most notable item on display is the couple's double-door

# THE KEY INGREDIENTS



The handsome **marble-topped island** features storage on both sides, and an alcove for two stools to tuck neatly underneath.

Stools, Sarah Richardson Design.



A pull-out **recycling drawer** keeps trips outside to the blue box to a minimum.



The **stainless steel wine fridge**, which has the appearance of sleek cabinetry, holds 200 bottles.

Fridge, CavaVin.



Elegant, **narrow shelves for wineglasses** take advantage of every inch of space, shoehorned in beside the wine fridge.



Stacked **stainless-steel ovens and a warming drawer** make cooking for a crowd easier for the couple, who entertain frequently.

stainless steel wine fridge. "The only thing we knew for sure was that we had to find space for our wine fridge," laughs Garrick, who enjoys sharing his collection of 150 bottles (which he calls a "sneeze" by true collectors' standards) with friends and family.

And yet the rigorously minimalist kitchen, like its owners, is both warm and inviting. The simplicity of the design is tempered by the choice of subtly different yet harmonious materials. The backsplash — an elegant tone-on-tone grid of different-sized Carrara marble tiles in a warm dove grey — is a fitting counterpoint to the crisp stainless steel countertop around the sink. Pendant canisters of soft pebbled glass and steel provide stylish task lighting and vertical interest. Narrow, elegant open shelves hold the couple's collection of fine glassware and cookery books. Says Richardson, "What makes this very modern kitchen work from a design perspective is that we took a streamlined approach but used a variety of interesting materials."

Various seating pods, from a pair of stools inset in the island, to a sunlit breakfast table looking out onto the back garden, and a sitting room with upholstered pieces adjacent to the wine — CONTINUED ON PAGE 302

## DESIGN SPECS

<b>CABINETS</b>	Painted wood
<b>COUNTERS</b>	Stainless steel, grey marble
<b>BACKSPLASH</b>	Grey Carrara marble tiles in two sizes
<b>HARDWARE</b>	Stainless steel industrial handles
<b>FAUCET</b>	Counter-mount stainless steel pot filler
<b>SINK</b>	Stainless steel double
<b>APPLIANCES</b>	Stainless steel
<b>FLOORING</b>	Dark-stained oak



*Can't live without...*  
*Mini soufflé dishes. A "recovering vegetarian," Thecla often serves individual soufflés when entertaining. These ceramic ramekins, in earthy black, and white with woven casings, suit the kitchen's neutral palette.*

Thecla loves the clean, sculptural look of the double ovens. "We see the kitchen as part of the entertaining space," she says. A small eating area looking out to the garden is serene with a minimalist pedestal table and a pair of keyhole-backed chairs. Table, Jesus Gasca chairs, Kiosk; ovens, KitchenAid.

